



GREENHILL



Blockmoor Cottage Clapgate

Albury, Ware, SG11 2JW

Guide price £425,000



Blockmoor Cottage Clapgate, Albury, Ware, SG11 2JW

Greenhill Estates proudly presents this enchanting and double-fronted three-bedroom thatched cottage, a Grade II listed building brimming with unique and character-rich details dating back to the early 1700's. Nestled in a sought-after village setting which dates back to as early as the 13th century, this charming home enjoys the tranquility of rural life steeped in history while still benefiting from excellent connectivity to nearby towns and major transport routes such as the A10, M11, A1, and M25.

Spanning two levels, the residence provides ample living space. The main features of the property are undoubtedly its stunning south-westerly facing garden, featuring an expansive lawn and a patio perfect for barbecues and outdoor gatherings as well as a large exclusive parking area with space for four cars.



Step Inside:

Step Outside:

Location:



Area Map



Floor Plan

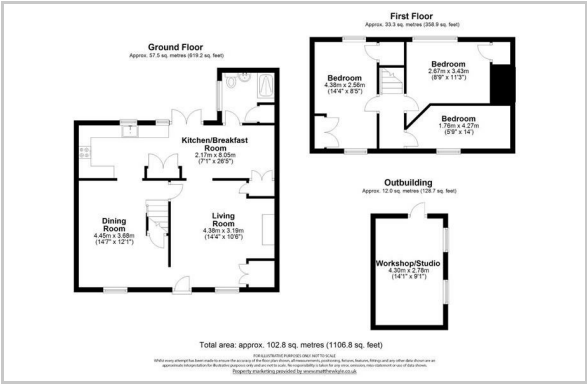

Energy Efficiency Graph

These particulars, whilst believed to be accurate are set out as a general outline only for guidance and do not constitute any part of an offer or contract. Intending purchasers should not rely on them as statements of representation of fact, but must satisfy themselves by inspection or otherwise as to their accuracy. No person in this firms employment has the authority to make or give any representation or warranty in respect of the property.